



01947 601301



6 HOWARDS COURT,
WHITBY

2 BED FLAT



WWW.HOPEANDBRAIMESTATEAGENTS.CO.UK



PROPERTY FEATURES

- First Floor Apartment with Allocated Parking
- 500 sq ft of Well Presented Accommodation
- 2 Bedrooms & Modern Shower Suite
- Gas Central Heating & Double-Glazing
- South-Facing Communal Gardens
- Close to Local Shops & Whitby's West Cliff
- 999 Year Lease from 1996 with an Annual Service Charge of £TBC
- Holiday letting is not permitted

Type: **FLAT**
Availability: **FOR SALE**
Bedrooms: **2**
Bathrooms: **1**
Reception Rooms: **1**
Parking: **ALLOCATED PARKING**
Outside Space: **COMMUNAL GARDENS**
Tenure: **LEASEHOLD**

01947 601301

www.hopeandbraimstateagents.co.uk



6 HOWARDS COURT, WHITBY - 2 bed Flat - £175,000



Hope & Braim are delighted to present 6 Howards Court in Whitby to the market. Conveniently located close to a parade of shops and with the Westcliff around the corner is this smart flat that also comes with private parking. A purpose-built block of ten flats with communal gardens at the front that faces south and a courtyard to the rear where there is private parking for the residents. The flat is on the first floor and has approximately 500 sq ft of accommodation that is well presented and benefits from having gas central heating and double-glazing throughout. There is a spacious lounge, a fully equipped kitchen, two bedrooms and a modern wet room, plus additional storage with two cupboards off the hallway. There is a restriction on the lease that prevents holiday letting so these flats are suitable for permanent residence, a private holiday home, or as a buy-to-let investment.



6 HOWARDS COURT, WHITBY - 2 bed Flat - £175,000

FIRST FLOOR
535 sq.ft. (49.7 sq.m.) approx.

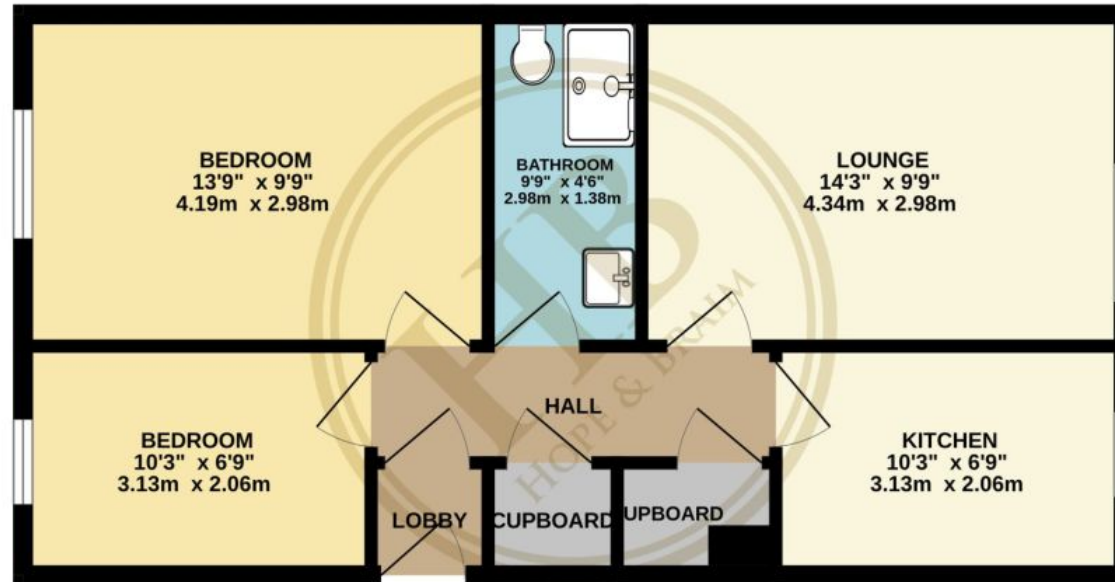

TOTAL FLOOR AREA : 535 sq.ft. (49.7 sq.m.) approx.

Whilst every attempt has been made to ensure the accuracy of the floorplan contained here, measurements of doors, windows, rooms and any other items are approximate and no responsibility is taken for any error, omission or mis-statement. This plan is for illustrative purposes only and should be used as such by any prospective purchaser. The services, systems and appliances shown have not been tested and no guarantee as to their operability or efficiency can be given.
Made with Metropix ©2023

Disclaimer: This brochure and property details are a representation of the property offered for sale or rent, as a guide only.

Brochure content must not be relied upon as fact and does not form any part of a contract. Measurements are approximate.

No fixtures or fittings, heating system or appliances have been tested, nor are they warranted by Hope & Braim or any staff member in any way as being functional or regulation compliant.

Hope & Braim do not accept any liability for any loss that may be caused directly or indirectly by the brochure content, all interested parties must rely on their own, their surveyor's or solicitor's findings.

We advise all interested parties to check with the local planning office for details of any application or decisions that may be consequential to your decision to purchase or rent any property.

Any floor plans provided should be used for illustrative purposes only and should be used as such by any interested party.

