



01947 601301



3 NORTH TERRACE,
FYLLINGTHORPE
4 BED END OF TERRACE HOUSE



WWW.HOPEANDBRAIMESTATEAGENTS.CO.UK



PROPERTY FEATURES

- Stunning Period Home with Contemporary Interiors
- High Ceilings and South-Facing Sash Windows
- 2 Reception Rooms & Breakfast Kitchen
- 4 Bedrooms & 2 Bathrooms including an En-Suite
- Gravelled Terrace with space for a Bistro Set
- Currently a Private Holiday Home and can come Fully Furnished

Type: **END OF TERRACE HOUSE**

Availability: **FOR SALE**

Bedrooms: **4**

Bathrooms: **2**

Reception Rooms: **2**

Parking: **ON ROAD PARKING**

Outside Space: **PATIO**

Tenure: **FREEHOLD**

01947 601301

www.hopeandbraimstateagents.co.uk

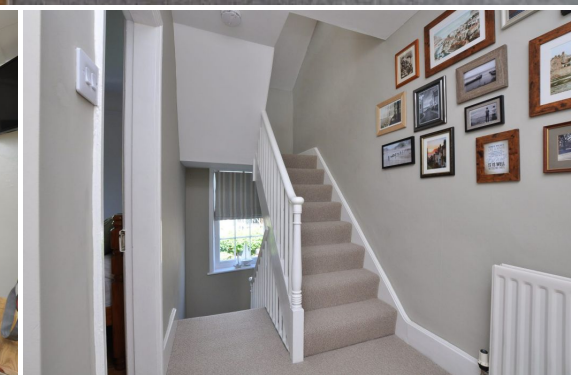

3 NORTH TERRACE, FYLINGTHORPE - 4 bed End of Terrace House - £325,000



Hope & Braim are delighted to present Eskcote on North Terrace in Fylingthorpe. This is a charming stone terrace with elegant interiors and a south facing façade with a small terrace located in rural village close to the coast. The property has been tastefully refurbished throughout with great care to preserve the period features including the high ceilings and the sash windows that flood this home with natural light. There are four floors and 1,300 sq ft of beautifully presented accommodation that benefit from having quality fixtures & fittings and modern gas central heating throughout. Steps from the street lead up to the ground floor that comprises a lounge at the front that has a large bay window, high ceilings with decorative mouldings and a feature fireplace with a living flame fire. At the back is a luxurious bathroom that has a four-piece suite comprising a roll top bath, step-in shower, wash hand basin and a WC. Downstairs there is a breakfast kitchen with bespoke cabinetry, a kitchen island with granite worktops and breakfast bar, plus a separate dining room with ample space for a dining table and seating for up to eight. On the upper floors there are four bedrooms with two doubles and a single on the first floor and a twin bedroom and en-suite shower room on the top floor. There are no gardens with the property but there is a gravelled terrace in front of the bay that has room for a bistro set. This is a much-loved holiday home but would also be suitable for permanent residence being close to local amenities and primary school.



3 NORTH TERRACE, FYLINGTHORPE - 4 bed End of Terrace House - £325,000

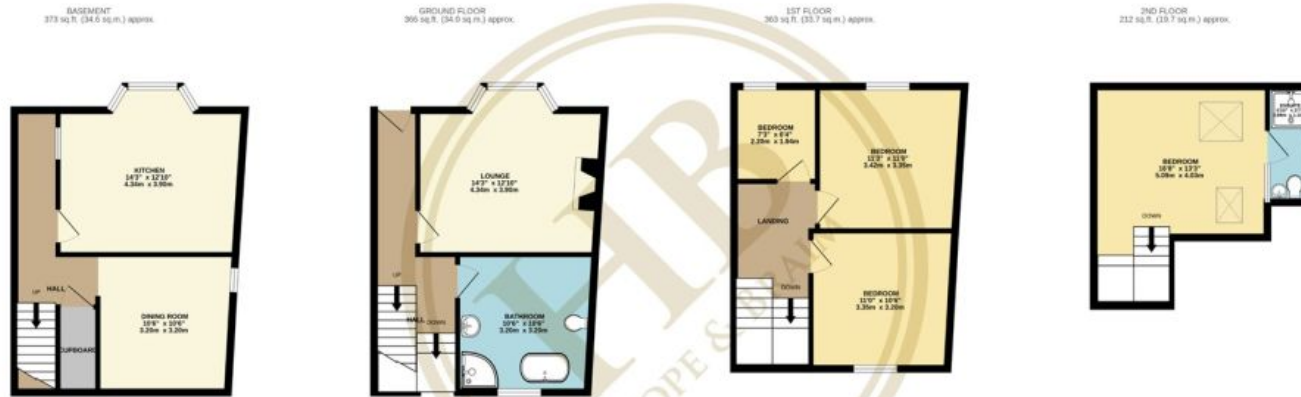

TOTAL FLOOR AREA: 1314 sq.ft. (122.1 sq.m.) approx.

Whilst every attempt has been made to ensure the accuracy of the floorplan contained here, measurements of doors, windows, rooms and any other items are approximate and no responsibility is taken for any error, omission or mis-statement. This plan is for illustrative purposes only and should be used as such by any prospective purchaser. The services, systems and appliances shown have not been tested and no guarantee as to their operability or efficiency can be given.
Made with Metropix ©2023



Disclaimer: This brochure and property details are a representation of the property offered for sale or rent, as a guide only.
 Brochure content must not be relied upon as fact and does not form any part of a contract. Measurements are approximate.
 No fixtures or fittings, heating system or appliances have been tested, nor are they warranted by Hope & Braim or any staff member in any way as being functional or regulation compliant.
 Hope & Braim do not accept any liability for any loss that may be caused directly or indirectly by the brochure content, all interested parties must rely on their own, their surveyor's or solicitor's findings.
 We advise all interested parties to check with the local planning office for details of any application or decisions that may be consequential to your decision to purchase or rent any property.
 Any floor plans provided should be used for illustrative purposes only and should be used as such by any interested party.