



01947 601301

THE ROCKPOOL,
CARRS YARD

1 BED COTTAGE



WWW.HOPEANDBRAIMESTATEAGENTS.CO.UK



PROPERTY FEATURES

- Period Cottage tucked away in the heart of The Old Town
- Beautifully presented with period features and coastal themed interiors
- 1 Reception Room with a fitted kitchen with integrated appliances
- 1 Bedroom with bespoke cabinetry & a modern bathroom
- Currently a successful holiday let that is being sold fully furnished & with bookings

Type: **COTTAGE**
Availability: **FOR SALE**
Bedrooms: **1**
Bathrooms: **1**
Reception Rooms: **1**
Outside Space: **YARD**

01947 601301

www.hopeandbraimstateagents.co.uk



THE ROCKPOOL, CARRS YARD - 1 bed Cottage - £199,950



Hope & Braim are delighted to present The Rock Pool on Carrs Yard, off Bagdale in Whitby to the market. This is the perfect holiday bolt hole that's conveniently located for access to the town and all the attractions this coastal town has to offer. A period property that was believed to be former stables for the nearby Manor House before becoming a fisherman's cottage that is now a successful holiday let. Although small this cottage has everything you could want from a central holiday home and benefits from having gas central heating and modern fixtures and fittings throughout. Downstairs there is a single room that has room for a three-seater sofa, a fitted kitchen in one corner with integrated appliances and space for a dining table with seating for two. Up the corkscrew staircase there is a bedroom with a double bed and bespoke cabinets and an adjoining bathroom with a three-piece suite including a shower over a three-quarter length bath. Outside there is a small yard in front of the cottage that has bench seating and can be enjoyed after a day exploring the town and nearby coast. The cottage comes fully furnished and with forward bookings, making this an attractive buy-to-let investment.



THE ROCKPOOL, CARRS YARD - 1 bed Cottage - £199,950

GROUND FLOOR
147 sq.ft. (13.6 sq.m.) approx.

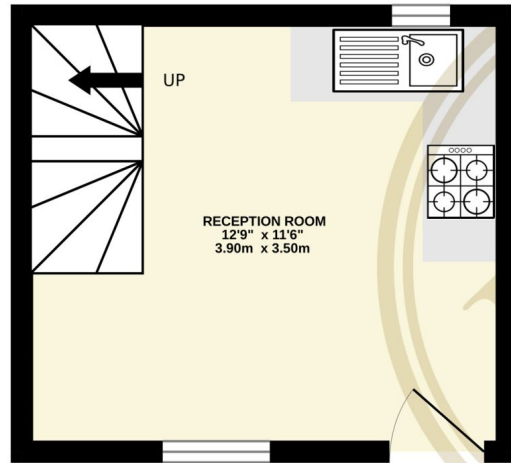

1ST FLOOR
147 sq.ft. (13.6 sq.m.) approx.

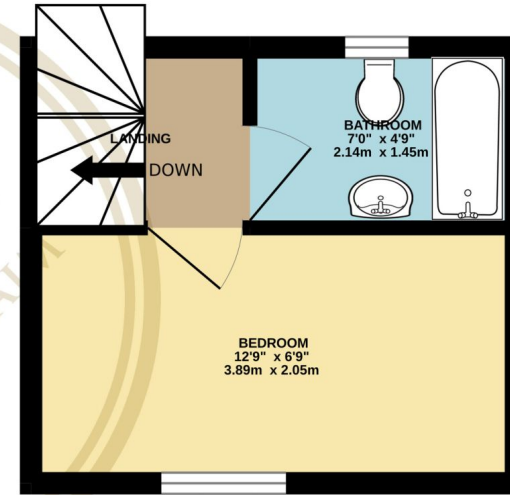

TOTAL FLOOR AREA : 294 sq.ft. (27.3 sq.m.) approx.

Whilst every attempt has been made to ensure the accuracy of the floorplan contained here, measurements of doors, windows, rooms and any other items are approximate and no responsibility is taken for any error, omission or mis-statement. This plan is for illustrative purposes only and should be used as such by any prospective purchaser. The services, systems and appliances shown have not been tested and no guarantee as to their operability or efficiency can be given.
Made with Metropix ©2022



Disclaimer: This brochure and property details are a representation of the property offered for sale or rent, as a guide only.

Brochure content must not be relied upon as fact and does not form any part of a contract. Measurements are approximate.

No fixtures or fittings, heating system or appliances have been tested, nor are they warranted by Hope & Braim or any staff member in any way as being functional or regulation compliant.

Hope & Braim do not accept any liability for any loss that may be caused directly or indirectly by the brochure content, all interested parties must rely on their own, their surveyor's or solicitor's findings.

We advise all interested parties to check with the local planning office for details of any application or decisions that may be consequential to your decision to purchase or rent any property.

Any floor plans provided should be used for illustrative purposes only and should be used as such by any interested party.

